

**PRODUCT
NEWS**

PN-E-014

SERIES EXPANSION

 **DIJET®**

FLAT DRILL Series

- **TLDM type** <Solid carbide drill>
- **TLD3D/TLD5D type** <Solid carbide drill>
- **TLZD type** <Indexable insert drill>

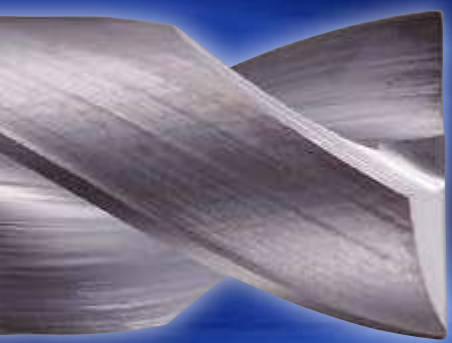

**180°
Flat face**



**180°
Flat face**



DIJET GmbH

www.dijet.de

Spot facing drill

Feature of product

Because of multi application, achieved process integration

The main usage

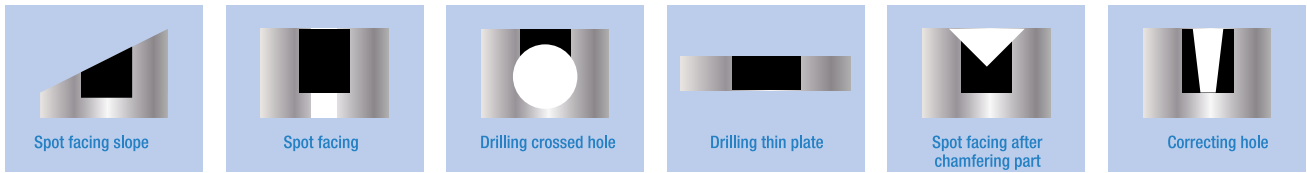

Example of process integration

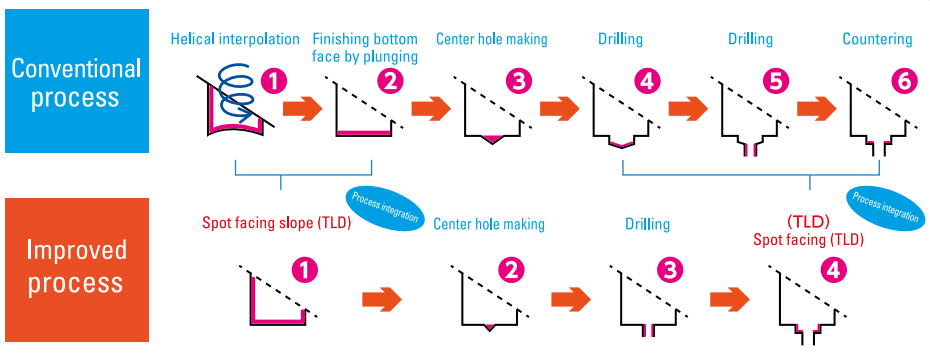

Widely applied from carbon & mold steel to stainless steel, cast iron & aluminum alloy

Restraining entrance burr and exit burr

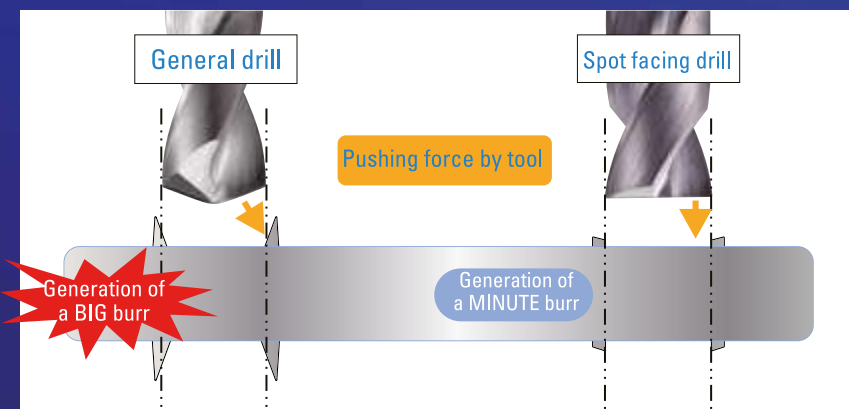

Useful in situations where burr processing is difficult, such as crossed hole processing

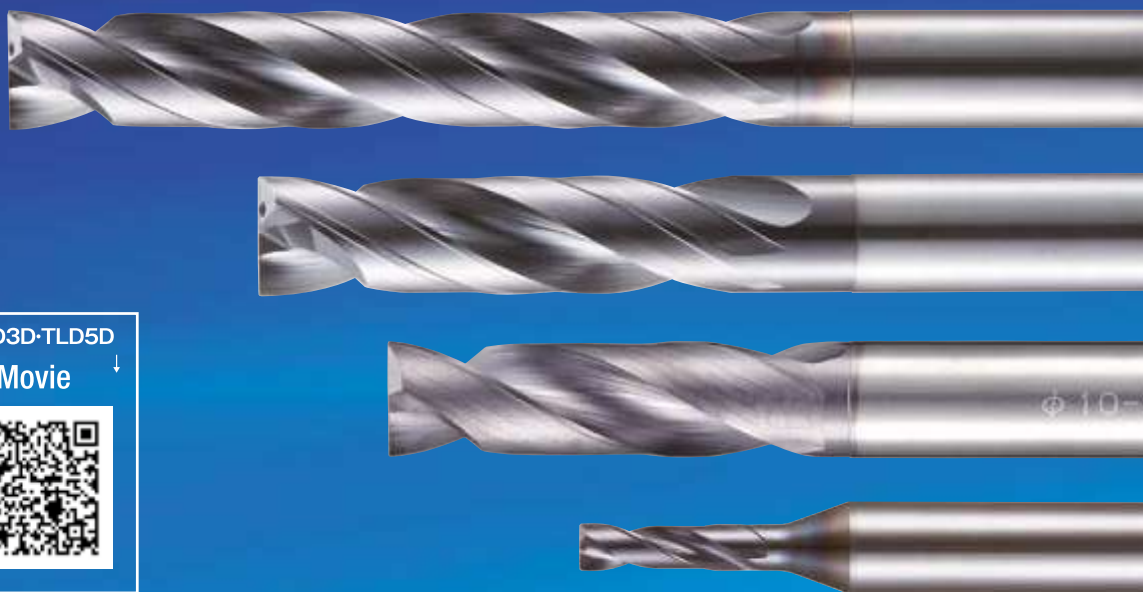

■ **TLDM** TLDM type (Drilling depth $2 \times D_c$)

Because of shortness overhung length, improved accuracy
Specializing in thin plate and bottom face processing

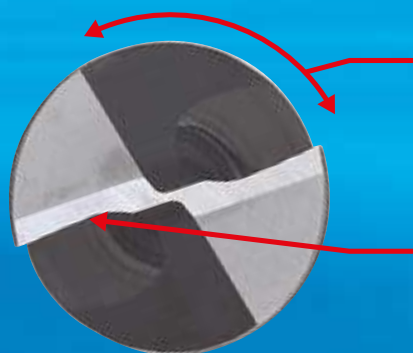

- Wide flute design
Good chip discharge performance
- Low cutting force
Excellent biting property

■ **TLD3D/TLD5D** TLD3D/5D type (Drilling depth $3 \times D_c / 5 \times D_c$)

Through coolant hole type
Specializing in deep hole drilling



- Wide flute design and
Smooth surface treatment
Good chip discharge performance
- Double margin shape
Improved straightness of the drilling
- Low cutting force
Excellent biting property

Line up

TLDM type

- Spot facing drill with point angle of 180° (flat face)
- Drilling depth 2×Dc
- Helix angle: 30°



Cat. No.	Stock	Dimensions (mm)			
		φDc	ℓ	L	φDs
TLDM010	○	1	3	60	3
TLDM011	○	1.1	3.3	60	3
TLDM012	○	1.2	3.6	60	3
TLDM013	○	1.3	3.9	60	3
TLDM014	○	1.4	4.2	60	3
TLDM015	○	1.5	4.5	60	3
TLDM016	○	1.6	4.8	60	3
TLDM017	○	1.7	5.1	60	3
TLDM018	○	1.8	5.4	60	3
TLDM019	○	1.9	5.7	60	3
TLDM020	○	2	7	60	4
TLDM021	○	2.1	7.5	60	4
TLDM022	○	2.2	8	60	4
TLDM023	○	2.3	8.5	60	4
TLDM024	○	2.4	9	60	4
TLDM025	○	2.5	9.5	60	4
TLDM026	○	2.6	10	60	4
TLDM027	○	2.7	10.5	60	4
TLDM028	○	2.8	11	60	4
TLDM029	○	2.9	11.5	60	4
TLDM030	○	3	12	60	4
TLDM030-S6	○	3	12	60	6
TLDM031	○	3.1	12	60	4
TLDM031-S6	○	3.1	12	60	6
TLDM032	○	3.2	12	60	4
TLDM032-S6	○	3.2	12	60	6
TLDM033	○	3.3	13	60	4
TLDM033-S6	○	3.3	13	60	6
TLDM034	○	3.4	13	60	4
TLDM034-S6	○	3.4	13	60	6
TLDM035	○	3.5	13	60	4
TLDM035-S6	○	3.5	13	60	6

Cat. No.	Stock	Dimensions (mm)			
		φDc	ℓ	L	φDs
TLDM036	○	3.6	14	60	4
TLDM036-S6	○	3.6	14	60	6
TLDM037	○	3.7	14	60	4
TLDM037-S6	○	3.7	14	60	6
TLDM038	○	3.8	15	60	4
TLDM038-S6	○	3.8	15	60	6
TLDM039	○	3.9	15	60	4
TLDM039-S6	○	3.9	15	60	6
TLDM040	○	4	15	60	4
TLDM040-S6	○	4	15	60	6
TLDM041	○	4.1	16	60	6
TLDM042	○	4.2	16	60	6
TLDM043	○	4.3	17	60	6
TLDM044	○	4.4	17	60	6
TLDM045	○	4.5	17	60	6
TLDM046	○	4.6	18	65	6
TLDM047	○	4.7	18	65	6
TLDM048	○	4.8	18	65	6
TLDM049	○	4.9	19	65	6
TLDM050	○	5	19	65	6
TLDM051	○	5.1	20	65	6
TLDM052	○	5.2	20	65	6
TLDM053	○	5.3	20	65	6
TLDM054	○	5.4	21	65	6
TLDM055	○	5.5	21	65	6
TLDM056	○	5.6	22	70	6
TLDM057	○	5.7	22	70	6
TLDM058	○	5.8	22	70	6
TLDM059	○	5.9	23	70	6
TLDM060	○	6	23	70	6
TLDM061	○	6.1	23	70	8
TLDM062	○	6.2	24	70	8

●: Standard stock item ○: Stock in Japan

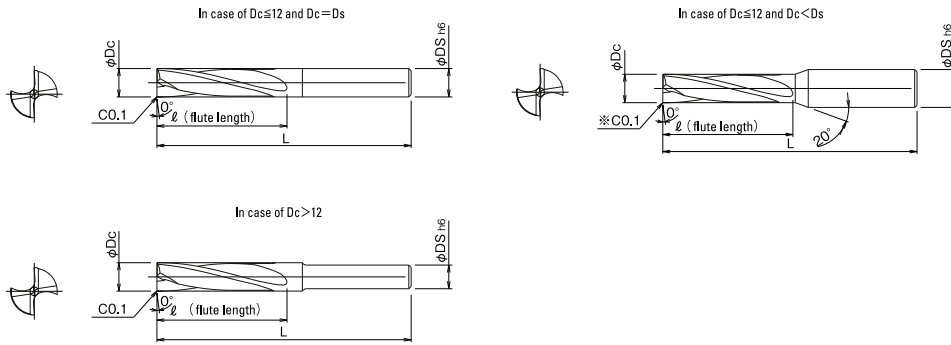

● Tolerance of drill diameter (mm)

Drill dia.	Tolerance
$Dc \leq 3$	$\begin{matrix} 0 \\ -0.010 \end{matrix}$
$3 < Dc \leq 6$	$\begin{matrix} 0 \\ -0.012 \end{matrix}$
$6 < Dc \leq 10$	$\begin{matrix} 0 \\ -0.015 \end{matrix}$
$10 < Dc \leq 18$	$\begin{matrix} 0 \\ -0.018 \end{matrix}$

Cat. No.	Stock	Dimensions (mm)			
		ϕDc	ℓ	L	ϕDs
TLDM063	○	6.3	24	70	8
TLDM064	○	6.4	25	70	8
TLDM065	○	6.5	25	70	8
TLDM066	○	6.6	25	75	8
TLDM067	○	6.7	26	75	8
TLDM068	○	6.8	26	75	8
TLDM069	○	6.9	27	75	8
TLDM070	○	7	27	75	8
TLDM071	○	7.1	27	75	8
TLDM072	○	7.2	28	75	8
TLDM073	○	7.3	28	75	8
TLDM074	○	7.4	28	75	8
TLDM075	○	7.5	29	75	8
TLDM076	○	7.6	29	75	8
TLDM077	○	7.7	30	75	8
TLDM078	○	7.8	30	75	8
TLDM079	○	7.9	30	75	8
TLDM080	○	8	31	75	8
TLDM081	○	8.1	31	75	10
TLDM082	○	8.2	32	75	10
TLDM083	○	8.3	32	75	10
TLDM084	○	8.4	32	75	10
TLDM085	○	8.5	32	75	10
TLDM086	○	8.6	33	80	10
TLDM087	○	8.7	33	80	10
TLDM088	○	8.8	34	80	10
TLDM089	○	8.9	34	80	10
TLDM090	○	9	35	80	10
TLDM091	○	9.1	35	80	10
TLDM092	○	9.2	35	80	10
TLDM093	○	9.3	36	80	10
TLDM094	○	9.4	36	80	10

Cat. No.	Stock	Dimensions (mm)			
		ϕDc	ℓ	L	ϕDs
TLDM095	○	9.5	37	80	10
TLDM096	○	9.6	37	80	10
TLDM097	○	9.7	37	80	10
TLDM098	○	9.8	38	80	10
TLDM099	○	9.9	38	80	10
TLDM100	○	10	39	80	10
TLDM101	○	10.1	39	85	12
TLDM102	○	10.2	39	85	12
TLDM103	○	10.3	40	85	12
TLDM104	○	10.4	40	85	12
TLDM105	○	10.5	40	85	12
TLDM106	○	10.6	41	85	12
TLDM107	○	10.7	41	85	12
TLDM108	○	10.8	42	85	12
TLDM109	○	10.9	42	85	12
TLDM110	○	11	42	85	12
TLDM111	○	11.1	43	85	12
TLDM112	○	11.2	43	85	12
TLDM113	○	11.3	44	85	12
TLDM114	○	11.4	44	85	12
TLDM115	○	11.5	44	85	12
TLDM116	○	11.6	45	90	12
TLDM117	○	11.7	45	90	12
TLDM118	○	11.8	45	90	12
TLDM119	○	11.9	46	90	12
TLDM120	○	12	46	90	12
TLDM125	○	12.5	48	95	12
TLDM130	○	13	50	100	12
TLDM135	○	13.5	52	100	12
TLDM140	○	14	54	100	12

●: Standard stock item ○: Stock in Japan

Recommended cutting conditions ↓



Line up

TLD3D type

- Spot facing drill with point angle of 180°(flat face)
- Through coolant hole
- Drilling depth 3×Dc
- Helix angle : 30°
- Double margin

Through
coolant
hole

DV
coating



Cat. No.	Stock	Dimensions (mm)			
		φDc	ℓ	L	φDs
TLD3DCH0300S03	●	3	14	60	3
TLD3DCH0310S04	●	3.1	14	60	4
TLD3DCH0320S04	●	3.2	15	60	4
TLD3DCH0330S04	●	3.3	15	60	4
TLD3DCH0340S04	●	3.4	16	60	4
TLD3DCH0350S04	●	3.5	16	60	4
TLD3DCH0360S04	●	3.6	17	60	4
TLD3DCH0370S04	●	3.7	17	60	4
TLD3DCH0380S04	●	3.8	18	60	4
TLD3DCH0390S04	●	3.9	18	60	4
TLD3DCH0400S04	●	4	18	60	4
TLD3DCH0410S05	●	4.1	19	65	5
TLD3DCH0420S05	●	4.2	19	65	5
TLD3DCH0430S05	●	4.3	20	65	5
TLD3DCH0440S05	●	4.4	20	65	5
TLD3DCH0450S05	●	4.5	21	65	5
TLD3DCH0460S05	●	4.6	21	65	5
TLD3DCH0470S05	●	4.7	22	65	5
TLD3DCH0480S05	●	4.8	22	65	5
TLD3DCH0490S05	●	4.9	23	65	5
TLD3DCH0500S05	●	5	23	65	5
TLD3DCH0510S06	●	5.1	23	70	6
TLD3DCH0520S06	●	5.2	24	70	6
TLD3DCH0530S06	●	5.3	24	70	6

Cat. No.	Stock	Dimensions (mm)			
		φDc	ℓ	L	φDs
TLD3DCH0540S06	●	5.4	25	70	6
TLD3DCH0550S06	●	5.5	25	70	6
TLD3DCH0560S06	●	5.6	26	70	6
TLD3DCH0570S06	●	5.7	26	70	6
TLD3DCH0580S06	●	5.8	27	70	6
TLD3DCH0590S06	●	5.9	27	70	6
TLD3DCH0600S06	●	6	27	70	6
TLD3DCH0610S07	●	6.1	28	75	7
TLD3DCH0620S07	●	6.2	28	75	7
TLD3DCH0630S07	●	6.3	29	75	7
TLD3DCH0640S07	●	6.4	29	75	7
TLD3DCH0650S07	●	6.5	30	75	7
TLD3DCH0660S07	●	6.6	30	75	7
TLD3DCH0670S07	●	6.7	31	75	7
TLD3DCH0680S07	●	6.8	31	75	7
TLD3DCH0690S07	●	6.9	32	75	7
TLD3DCH0700S07	●	7	32	75	7
TLD3DCH0710S08	●	7.1	32	80	8
TLD3DCH0720S08	●	7.2	33	80	8
TLD3DCH0730S08	●	7.3	33	80	8
TLD3DCH0740S08	●	7.4	34	80	8
TLD3DCH0750S08	●	7.5	34	80	8
TLD3DCH0760S08	●	7.6	35	80	8
TLD3DCH0770S08	●	7.7	35	80	8

● Standard stock item ○ Stock in Japan

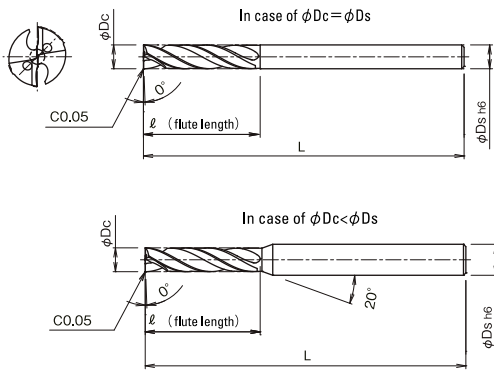

● Tolerance of drill diameter (mm)

Drill dia.	Tolerance
$D_c \leq 3$	$\begin{matrix} 0 \\ -0.010 \end{matrix}$
$3 < D_c \leq 6$	$\begin{matrix} 0 \\ -0.012 \end{matrix}$
$6 < D_c \leq 10$	$\begin{matrix} 0 \\ -0.015 \end{matrix}$
$10 < D_c \leq 18$	$\begin{matrix} 0 \\ -0.018 \end{matrix}$

Cat. No.	Stock	Dimensions (mm)			
		ϕD_c	ℓ	L	ϕD_s
TLD3DCH0780S08	●	7.8	36	80	8
TLD3DCH0790S08	●	7.9	36	80	8
TLD3DCH0800S08	●	8	36	80	8
TLD3DCH0810S09	●	8.1	37	90	9
TLD3DCH0820S09	●	8.2	37	90	9
TLD3DCH0830S09	●	8.3	38	90	9
TLD3DCH0840S09	●	8.4	38	90	9
TLD3DCH0850S09	●	8.5	39	90	9
TLD3DCH0860S09	●	8.6	39	90	9
TLD3DCH0870S09	●	8.7	40	90	9
TLD3DCH0880S09	●	8.8	40	90	9
TLD3DCH0890S09	●	8.9	41	90	9
TLD3DCH0900S09	●	9	41	90	9
TLD3DCH0910S10	●	9.1	41	95	10
TLD3DCH0920S10	●	9.2	42	95	10
TLD3DCH0930S10	●	9.3	42	95	10
TLD3DCH0940S10	●	9.4	43	95	10
TLD3DCH0950S10	●	9.5	43	95	10
TLD3DCH0960S10	●	9.6	44	95	10
TLD3DCH0970S10	●	9.7	44	95	10
TLD3DCH0980S10	●	9.8	45	95	10
TLD3DCH0990S10	●	9.9	45	95	10
TLD3DCH1000S10	●	10	45	95	10
TLD3DCH1010S11	●	10.1	46	105	11

Cat. No.	Stock	Dimensions (mm)			
		ϕD_c	ℓ	L	ϕD_s
TLD3DCH1020S11	●	10.2	46	105	11
TLD3DCH1030S11	●	10.3	47	105	11
TLD3DCH1040S11	●	10.4	47	105	11
TLD3DCH1050S11	●	10.5	48	105	11
TLD3DCH1060S11	●	10.6	48	105	11
TLD3DCH1070S11	●	10.7	49	105	11
TLD3DCH1080S11	●	10.8	49	105	11
TLD3DCH1090S11	●	10.9	50	105	11
TLD3DCH1100S11	●	11	50	105	11
TLD3DCH1110S12	●	11.1	50	115	12
TLD3DCH1120S12	●	11.2	51	115	12
TLD3DCH1130S12	●	11.3	51	115	12
TLD3DCH1140S12	●	11.4	52	115	12
TLD3DCH1150S12	●	11.5	52	115	12
TLD3DCH1160S12	●	11.6	53	115	12
TLD3DCH1170S12	●	11.7	53	115	12
TLD3DCH1180S12	●	11.8	54	115	12
TLD3DCH1190S12	●	11.9	54	115	12
TLD3DCH1200S12	●	12	54	115	12
TLD3DCH1250S13	●	12.5	57	125	13
TLD3DCH1300S13	●	13	59	125	13
TLD3DCH1350S14	●	13.5	61	130	14
TLD3DCH1400S14	●	14	63	130	14

● Standard stock item ○ Stock in Japan

Recommended cutting conditions ↓



Line up

TLD5D type

- Spot facing drill with point angle of 180°(flat face)
- Through coolant hole
- Drilling depth 5×Dc
- Helix angle: 30°
- Double margin

Through
coolant
hole

DV
coating



Cat. No.	Stock	Dimensions (mm)			
		φDc	ℓ	L	φDs
TLD5DCH0300S03	○	3	20	70	3
TLD5DCH0310S04	○	3.1	21	70	4
TLD5DCH0320S04	○	3.2	22	70	4
TLD5DCH0330S04	○	3.3	22	70	4
TLD5DCH0340S04	○	3.4	23	70	4
TLD5DCH0350S04	○	3.5	24	70	4
TLD5DCH0360S04	○	3.6	24	70	4
TLD5DCH0370S04	○	3.7	25	70	4
TLD5DCH0380S04	○	3.8	26	70	4
TLD5DCH0390S04	○	3.9	26	70	4
TLD5DCH0400S04	○	4	27	70	4
TLD5DCH0410S05	○	4.1	28	80	5
TLD5DCH0420S05	○	4.2	28	80	5
TLD5DCH0430S05	○	4.3	29	80	5
TLD5DCH0440S05	○	4.4	30	80	5
TLD5DCH0450S05	○	4.5	30	80	5
TLD5DCH0460S05	○	4.6	31	80	5
TLD5DCH0470S05	○	4.7	32	80	5
TLD5DCH0480S05	○	4.8	32	80	5
TLD5DCH0490S05	○	4.9	33	80	5
TLD5DCH0500S05	○	5	34	80	5
TLD5DCH0510S06	○	5.1	34	85	6
TLD5DCH0520S06	○	5.2	35	85	6
TLD5DCH0530S06	○	5.3	36	85	6

Cat. No.	Stock	Dimensions (mm)			
		φDc	ℓ	L	φDs
TLD5DCH0540S06	○	5.4	36	85	6
TLD5DCH0550S06	○	5.5	37	85	6
TLD5DCH0560S06	○	5.6	38	85	6
TLD5DCH0570S06	○	5.7	38	85	6
TLD5DCH0580S06	○	5.8	39	85	6
TLD5DCH0590S06	○	5.9	40	85	6
TLD5DCH0600S06	○	6	40	85	6
TLD5DCH0610S07	○	6.1	41	95	7
TLD5DCH0620S07	○	6.2	42	95	7
TLD5DCH0630S07	○	6.3	42	95	7
TLD5DCH0640S07	○	6.4	43	95	7
TLD5DCH0650S07	○	6.5	44	95	7
TLD5DCH0660S07	○	6.6	44	95	7
TLD5DCH0670S07	○	6.7	45	95	7
TLD5DCH0680S07	○	6.8	46	95	7
TLD5DCH0690S07	○	6.9	46	95	7
TLD5DCH0700S07	○	7	47	95	7
TLD5DCH0710S08	○	7.1	48	100	8
TLD5DCH0720S08	○	7.2	48	100	8
TLD5DCH0730S08	○	7.3	49	100	8
TLD5DCH0740S08	○	7.4	50	100	8
TLD5DCH0750S08	○	7.5	50	100	8
TLD5DCH0760S08	○	7.6	51	100	8
TLD5DCH0770S08	○	7.7	52	100	8

● Standard stock item ○ Stock in Japan

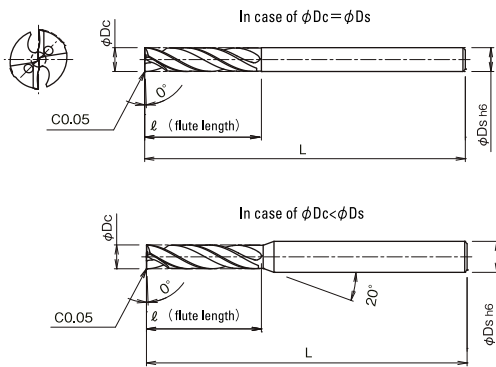

● Tolerance of drill diameter (mm)

Drill dia.	Tolerance
$D_c \leq 3$	$\begin{matrix} 0 \\ -0.010 \end{matrix}$
$3 < D_c \leq 6$	$\begin{matrix} 0 \\ -0.012 \end{matrix}$
$6 < D_c \leq 10$	$\begin{matrix} 0 \\ -0.015 \end{matrix}$
$10 < D_c \leq 18$	$\begin{matrix} 0 \\ -0.018 \end{matrix}$

Cat. No.	Stock	Dimensions (mm)			
		ϕD_c	ℓ	L	ϕD_s
TLD5DCH0780S08	○	7.8	52	100	8
TLD5DCH0790S08	○	7.9	53	100	8
TLD5DCH0800S08	○	8	54	100	8
TLD5DCH0810S09	○	8.1	54	110	9
TLD5DCH0820S09	○	8.2	55	110	9
TLD5DCH0830S09	○	8.3	56	110	9
TLD5DCH0840S09	○	8.4	56	110	9
TLD5DCH0850S09	○	8.5	57	110	9
TLD5DCH0860S09	○	8.6	58	110	9
TLD5DCH0870S09	○	8.7	58	110	9
TLD5DCH0880S09	○	8.8	59	110	9
TLD5DCH0890S09	○	8.9	60	110	9
TLD5DCH0900S09	○	9	60	110	9
TLD5DCH0910S10	○	9.1	61	120	10
TLD5DCH0920S10	○	9.2	62	120	10
TLD5DCH0930S10	○	9.3	62	120	10
TLD5DCH0940S10	○	9.4	63	120	10
TLD5DCH0950S10	○	9.5	64	120	10
TLD5DCH0960S10	○	9.6	64	120	10
TLD5DCH0970S10	○	9.7	65	120	10
TLD5DCH0980S10	○	9.8	66	120	10
TLD5DCH0990S10	○	9.9	66	120	10
TLD5DCH1000S10	○	10	67	120	10
TLD5DCH1010S11	○	10.1	68	130	11

Cat. No.	Stock	Dimensions (mm)			
		ϕD_c	ℓ	L	ϕD_s
TLD5DCH1020S11	○	10.2	68	130	11
TLD5DCH1030S11	○	10.3	69	130	11
TLD5DCH1040S11	○	10.4	70	130	11
TLD5DCH1050S11	○	10.5	70	130	11
TLD5DCH1060S11	○	10.6	71	130	11
TLD5DCH1070S11	○	10.7	72	130	11
TLD5DCH1080S11	○	10.8	72	130	11
TLD5DCH1090S11	○	10.9	73	130	11
TLD5DCH1100S11	○	11	74	130	11
TLD5DCH1110S12	○	11.1	74	145	12
TLD5DCH1120S12	○	11.2	75	145	12
TLD5DCH1130S12	○	11.3	76	145	12
TLD5DCH1140S12	○	11.4	76	145	12
TLD5DCH1150S12	○	11.5	77	145	12
TLD5DCH1160S12	○	11.6	78	145	12
TLD5DCH1170S12	○	11.7	78	145	12
TLD5DCH1180S12	○	11.8	79	145	12
TLD5DCH1190S12	○	11.9	80	145	12
TLD5DCH1200S12	○	12	80	145	12
TLD5DCH1250S13	○	12.5	84	155	13
TLD5DCH1300S13	○	13	87	155	13
TLD5DCH1350S14	○	13.5	90	160	14
TLD5DCH1400S14	○	14	94	160	14

● Standard stock item ○ Stock in Japan

Recommended cutting conditions ↓



"Indexable Spot facing drill" TLZD type



- Flat face
- Achieved non-step drilling
- Size range: $\phi 14$ - $\phi 32$ mm dia.(Drilling depth: 1.5D)

Application

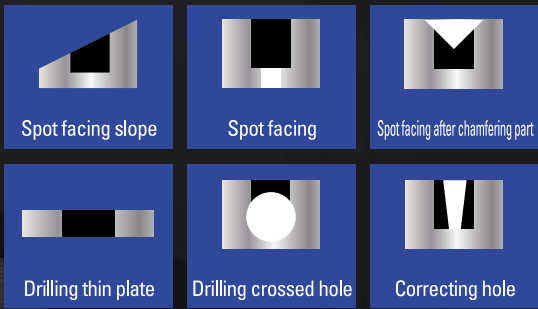

Feature of product

Features 1

TLZD can be used repeatedly only by exchanging insert. Easy assembly of insert & body.

Features 2

Achieved non-step drilling without pilot hole even if drilling slope surface and crossed hole.

Features 3

By adopting new PVD coated grade "JC7550" and unique coolant system, achieved longer tool life even if drilling mold steel or stainless steel.

Features 4

Controlled burr in case of drilling thin plate.

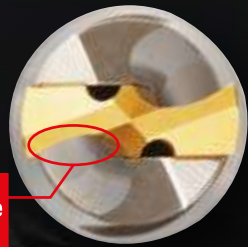

Wavy cutting edge



Achieved low cutting force

Exclusive design body for TLZD.



TLZD



Series expansion, new modular head
TLZD type (flat face).

Suitable for spot facing in case of
long overhung length such as stamping die or
large-sized mold part.

Feature of product

Features 1

Size range: $\phi 14$ - $\phi 32$ mm dia. And even in case of long overhung length, stable machining can be possible by combination with MSN carbide shank arbor.



Features 2

Achieved non-step drilling without pilot hole even if drilling slope surface and crossed hole.

Features 3

By adopting new PVD coated grade "JC7550" and unique coolant system, achieved longer tool life even if drilling mold steel or stainless steel.

Features 4

Drilling depth: 0.7-1D.

"Indexable Spot facing drill" TLZD type

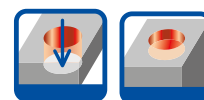

Line up

TLZD-SS type

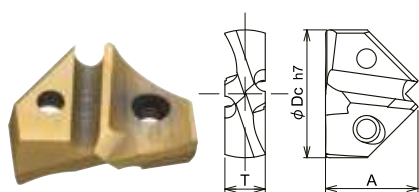

- Through coolant hole
- Drilling depth : 1.5×Dc
- SS type (1.5D)



Insert			Body					Parts							
Drill dia. (mm)	Insert		Dimensions (mm)		Applicable dia.		SS type (1.5D)					Clamp screw	Wrench (Not be included)		
	Insert No.	PVD coated	A	T	Over	Or under	Tool No.	Stock	Dimensions (mm)						
φDc	JC7550									ℓ	ℓ ₂	ℓ _s	L	φD _s	
14	TLZ1400	●	10.6	4.5	13.5	14.5	TLZD1400S16-SS	●	29	43	48	91	16	DSW-2045H	A-07
14.1	TLZ1410	●													
14.2	TLZ1420	●													
14.3	TLZ1430	●													
14.4	TLZ1440	●													
14.5	TLZ1450	●													
14.6	TLZ1460	●	11.3	4.8	14.5	15.5	TLZD1500S20-SS	●	31	46	50	96	20	DSW-2045H	A-07
14.7	TLZ1470	●													
14.8	TLZ1480	●													
14.9	TLZ1490	●													
15	TLZ1500	●													
15.1	TLZ1510	●													
15.2	TLZ1520	●	12.1	5.0	15.5	16.5	TLZD1600S20-SS	●	33	49	50	99	20	TSW-2556H	A-08
15.3	TLZ1530	●													
15.4	TLZ1540	●													
15.5	TLZ1550	●													
15.6	TLZ1560	●													
15.7	TLZ1570	●													
15.8	TLZ1580	●	12.6	5.5	16.5	17.5	TLZD1700S20-SS	●	35	52	50	102	20	TSW-2556H	A-08
15.9	TLZ1590	●													
16	TLZ1600	●													
16.1	TLZ1610	●													
16.2	TLZ1620	●													
16.3	TLZ1630	●													
16.4	TLZ1640	●	13.2	5.8	17.5	18.5	TLZD1800S20-SS	●	37	55	50	105	20	TSW-2556H	A-08
16.5	TLZ1650	●													
16.6	TLZ1660	●													
16.7	TLZ1670	●													
16.8	TLZ1680	●													
16.9	TLZ1690	●													
17	TLZ1700	●													
17.1	TLZ1710	●													
17.2	TLZ1720	●													
17.3	TLZ1730	●													
17.4	TLZ1740	●													
17.5	TLZ1750	●													
17.6	TLZ1760	●													
17.7	TLZ1770	●													
17.8	TLZ1780	●													
17.9	TLZ1790	●													
18	TLZ1800	●													
18.1	TLZ1810	●													
18.2	TLZ1820	●													
18.3	TLZ1830	●													
18.4	TLZ1840	●													
18.5	TLZ1850	●													

Clamp screw	Recommended torque (N·m)
DSW-2045H	0.9
TSW-2556H	1.2
TSW-2567H	1.2
DSW-307H	2.1
DSW-309H	2.1
TSW-3510H	3.0
TSW-3512H	3.0

$\phi Dc \leq \phi 30$

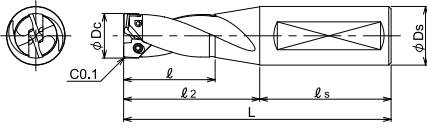

$\phi Dc > \phi 30$

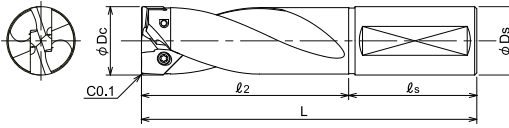

■ Insert

■ Body

■ Parts

2/2

Drill dia. (mm)	Insert				Body								Parts		
	Insert No.	PVD coated	Dimensions (mm)		Applicable dia.		SS type (1.5D)						Clamp screw	Wrench (Not be included)	
		JC7550	A	T	Over	Or under	Tool No.	Stock	Dimensions (mm)						
ϕDc								l	l_2	l_s	L	ϕDs			
18.6	TLZ1860	●	13.6	6.0	18.5	19.5	TLZD1900S25-SS	●	39	58	56	114	25	TSW-2567H	A-08
18.7	TLZ1870	●													
18.8	TLZ1880	●													
18.9	TLZ1890	●													
19	TLZ1900	●													
19.1	TLZ1910	●													
19.2	TLZ1920	●													
19.3	TLZ1930	●													
19.4	TLZ1940	●													
19.5	TLZ1950	●													
19.6	TLZ1960	●	14.6	6.5	19.5	20.5	TLZD2000S25-SS	●	41	61	56	117	25	TSW-2567H	A-08
19.7	TLZ1970	●													
19.8	TLZ1980	●													
19.9	TLZ1990	●													
20	TLZ2000	●													
20.5	TLZ2050	●													
21	TLZ2100	●	15.2	6.7	20.5	21.5	TLZD2100S25-SS	●	43	64	56	120	25	TSW-2567H	A-08
21.5	TLZ2150	●													
22	TLZ2200	●													
22.5	TLZ2250	●	15.9	7.5	21.5	22.5	TLZD2200S25-SS	●	45	67	56	123	25	DSW-307H	A-10
23	TLZ2300	●													
23.5	TLZ2350	●	16.7	7.5	22.5	23.5	TLZD2300S25-SS	●	47	70	56	126	25	DSW-307H	A-10
24	TLZ2400	●													
24.5	TLZ2450	●	17.4	8.0	23.5	24.5	TLZD2400S32-SS	●	49	73	60	133	32	DSW-307H	A-10
25	TLZ2500	●													
25.5	TLZ2550	●													
26	TLZ2600	●	18.3	8.0	24.5	25.5	TLZD2500S32-SS	●	51	76	60	136	32	DSW-309H	A-10
26.5	TLZ2650	●													
27	TLZ2700	●	18.8	8.5	25.5	26.5	TLZD2600S32-SS	●	53	79	60	139	32	DSW-309H	A-10
27.5	TLZ2750	●													
28	TLZ2800	●	19.5	8.5	26.5	27.5	TLZD2700S32-SS	●	55	82	60	142	32	DSW-309H	A-10
28.5	TLZ2850	●													
29	TLZ2900	●													
29.5	TLZ2950	●	20.3	9.0	27.5	28.5	TLZD2800S32-SS	●	57	85	60	145	32	TSW-3510H	A-15
30	TLZ3000	●													
30.5	TLZ3050	●	21.1	9.0	28.5	29.5	TLZD2900S32-SS	●	59	88	60	148	32	TSW-3510H	A-15
31	TLZ3100	●													
31.5	TLZ3150	●	21.5	9.5	29.5	30.5	TLZD3000S32-SS	●	61	91	60	151	32	TSW-3510H	A-15
32	TLZ3200	●													
		●	22.3	10.0	30.5	31.5	TLZD3100S32-SS	●	-	94	60	154	32	TSW-3512H	A-15
		●													
		●	23.1	10.0	31.5	32.5	TLZD3200S32-SS	●	-	97	60	157	32	TSW-3512H	A-15
		●													

1 insert per case ● : Standard stock items

Note) All cutters are supplied without inserts, wrench and MOLY.

Recommended cutting conditions ↓



"Indexable Spot facing drill" TLZD type

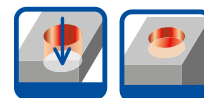

Line up

TLZD type (modular head)

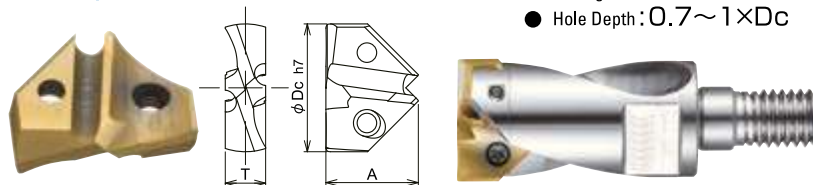

- Through coolant hole
- Hole Depth: 0.7~1×Dc

Insert			Body				Parts		Recommended arbor							
Drill dia. (mm)	Insert		Dimensions (mm)		Applicable dia.		TLZD type (0.7-1D)					Clamp screw	Wrench (Not be included)	Arbor		
	Insert No.	PVD coated	A	T	Over	Or under	Tool No.	Stock	Dimensions (mm)							
φDc		JC7550							Lf	φDb	MD	C	W			
14	TLZ1400	●	10.6	4.5	13.5	14.5	TLZD1400-M6	●	27.5	13.1	M6	7	10	DSW-2045H	A-07	MSN-M6-**-S16C
14.1	TLZ1410	●														
14.2	TLZ1420	●														
14.3	TLZ1430	●														
14.4	TLZ1440	●														
14.5	TLZ1450	●														
14.6	TLZ1460	●	11.3	4.8	14.5	15.5	TLZD1500-M8	●	29.5	14	M8	8	12	DSW-2045H	A-07	MSN-M8-**-S-S14C
14.7	TLZ1470	●														
14.8	TLZ1480	●														
14.9	TLZ1490	●														
15	TLZ1500	●														
15.1	TLZ1510	●														
15.2	TLZ1520	●														
15.3	TLZ1530	●														
15.4	TLZ1540	●														
15.5	TLZ1550	●														
15.6	TLZ1560	●	12.1	5.0	15.5	16.5	TLZD1600-M8	●	29.5	15	M8	8	12	TSW-2556H	A-08	MSN-M8-**-S-S15C
15.7	TLZ1570	●														
15.8	TLZ1580	●														
15.9	TLZ1590	●														
16	TLZ1600	●														
16.1	TLZ1610	●														
16.2	TLZ1620	●														
16.3	TLZ1630	●														
16.4	TLZ1640	●														
16.5	TLZ1650	●														
16.6	TLZ1660	●	12.6	5.5	16.5	17.5	TLZD1700-M8	●	30.5	16	M8	8	12	TSW-2556H	A-08	MSN-M8-**-S-S16C
16.7	TLZ1670	●														
16.8	TLZ1680	●														
16.9	TLZ1690	●														
17	TLZ1700	●														
17.1	TLZ1710	●														
17.2	TLZ1720	●														
17.3	TLZ1730	●														
17.4	TLZ1740	●														
17.5	TLZ1750	●														
17.6	TLZ1760	●	13.2	5.8	17.5	18.5	TLZD1800-M8	●	30.5	17	M8	8	12	TSW-2556H	A-08	MSN-M8-**-S-S16C
17.7	TLZ1770	●														
17.8	TLZ1780	●														
17.9	TLZ1790	●														
18	TLZ1800	●														
18.1	TLZ1810	●														
18.2	TLZ1820	●														
18.3	TLZ1830	●														
18.4	TLZ1840	●														
18.5	TLZ1850	●														

Clamp screw	Recommended torque (N·m)
DSW-2045H	0.9
TSW-2556H	1.2
TSW-2567H	1.2
DSW-307H	2.1
DSW-309H	2.1
TSW-3510H	3.0
TSW-3512H	3.0

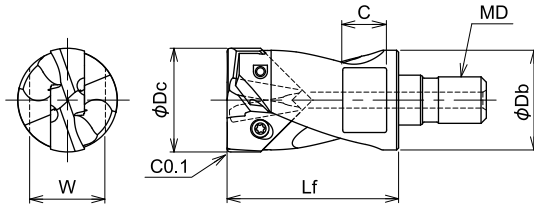

Insert			Body				Parts		Recommended arbor							
Drill dia. (mm)	Insert		Dimensions (mm)		Applicable dia.		TLZD type (0.7-1D)					Clamp screw	Wrench (Not be included)	Arbor		
	Insert No.	PVD coated	A	T	Over	Or under	Tool No.	Stock	Dimensions (mm)							
φDc	JC7550							Lf	φDb	MD	C	W				
18.6	TLZ1860	●	13.6	6.0	18.5	19.5	TLZD1900-M10	●	38.5	18	M10	9	14	TSW-2567H	A-08	MSN-M10-***S-18C
18.7	TLZ1870	●														
18.8	TLZ1880	●														
18.9	TLZ1890	●														
19	TLZ1900	●														
19.1	TLZ1910	●	14.6	6.5	19.5	20.5	TLZD2000-M10	●	38.5	19	M10	9	14	TSW-2567H	A-08	MSN-M10-**-S20C
19.2	TLZ1920	●														
19.3	TLZ1930	●														
19.4	TLZ1940	●														
19.5	TLZ1950	●														
19.6	TLZ1960	●	15.2	6.7	20.5	21.5	TLZD2100-M10	●	38.5	20	M10	9	14	TSW-2567H	A-08	MSN-M10-***S-20C
19.7	TLZ1970	●														
19.8	TLZ1980	●														
19.9	TLZ1990	●														
20	TLZ2000	●														
20.5	TLZ2050	●	15.9	7.5	21.5	22.5	TLZD2200-M10	●	38.5	21	M10	9	14	DSW-307H	A-10	MSN-M10-***S-20C
21	TLZ2100	●														
21.5	TLZ2150	●														
22	TLZ2200	●														
22.5	TLZ2250	●														
23	TLZ2300	●	16.7	7.5	22.5	23.5	TLZD2300-M10	●	38.5	22	M10	9	14	DSW-307H	A-10	MSN-M10-***S-20C
23.5	TLZ2350	●														
24	TLZ2400	●														
24.5	TLZ2450	●														
25	TLZ2500	●														
25.5	TLZ2550	●	17.4	8.0	23.5	24.5	TLZD2400-M12	●	43	23	M12	11	19	DSW-307H	A-10	MSN-M12-***S-23C
26	TLZ2600	●														
26.5	TLZ2650	●														
27	TLZ2700	●														
27.5	TLZ2750	●														
28	TLZ2800	●	18.3	8.0	24.5	25.5	TLZD2500-M12	●	43	24	M12	11	19	DSW-309H	A-10	MSN-M12-**-S25C
28.5	TLZ2850	●														
29	TLZ2900	●														
29.5	TLZ2950	●														
30	TLZ3000	●														
30.5	TLZ3050	●	18.8	8.5	25.5	26.5	TLZD2600-M12	●	43	25	M12	11	19	DSW-309H	A-10	MSN-M12-***S-25C
31	TLZ3100	●														
31.5	TLZ3150	●														
32	TLZ3200	●														
32.5	TLZ3250	●														
32	TLZ3200	●	19.5	8.5	26.5	27.5	TLZD2700-M12	●	43	26	M12	11	19	DSW-309H	A-10	MSN-M12-***S-25C
27	TLZ2700	●														
27.5	TLZ2750	●														
28	TLZ2800	●														
28.5	TLZ2850	●														
29	TLZ2900	●	20.3	9.0	27.5	28.5	TLZD2800-M12	●	43	27	M12	11	19	TSW-3510H	A-15	MSN-M12-***S-25C
28.5	TLZ2850	●														
29	TLZ2900	●														
29.5	TLZ2950	●														
30	TLZ3000	●														
30.5	TLZ3050	●	21.1	9.0	28.5	29.5	TLZD2900-M16	●	51	28	M16	12	22	TSW-3510H	A-15	MSN-M16-***S-28C
29.5	TLZ2950	●														
30	TLZ3000	●														
30.5	TLZ3050	●														
31	TLZ3100	●														
31.5	TLZ3150	●	21.5	9.5	29.5	30.5	TLZD3000-M16	●	51	29	M16	12	22	TSW-3510H	A-15	MSN-M16-**-S32C
30.5	TLZ3050	●														
31	TLZ3100	●														
31.5	TLZ3150	●														
32	TLZ3200	●														
31.5	TLZ3150	●	22.3	10.0	30.5	31.5	TLZD3100-M16	●	51	30	M16	12	22	TSW-3512H	A-15	MSN-M16-***S-32C
31.5	TLZ3150	●														
32	TLZ3200	●														
32.5	TLZ3250	●														
32	TLZ3200	●														
32	TLZ3200	●														
32.5	TLZ3250	●														
32	TLZ3200	●														
32.5	TLZ3250	●														

1 insert per case ● : Standard stock items

Note) All cutters are supplied without inserts, wrench and MOLY.

Recommended cutting conditions ↓





HEADQUARTER

DIJET Industrial Co.Ltd.
2-1-18, Kami-Higashi,
Hirano-ku, Osaka 547-0002, Japan
Phone: +81-6-6791-6781
Fax: +81-6-6793-1221
www.dijet.co.jp

MAIN OFFICE EUROPE

DIJET GmbH
Immemannstraße 9
40210 Düsseldorf, Germany
Phone: +49-211-5008820
Fax: +49-211-5008823
www.dijet.de



DIJET EUROPE



Web : www.dijet.de

